



External thrusters

Sleipner's external thrusters are as compact as it gets and offer many attractive benefits for boat builders as well as retrofit installations. The versatile installation and compact size make them the perfect choice for vessels where the inside configuration does not allow for a standard thruster installation.

DC electric external thrusters are typically mounted underneath the hull in a streamlined hydrodynamic pod as a bow and stern thruster and are best suited on displacement or semi-planning hulls. The optimal design adds minimal drag and will, in most installations, not be noticeable.

Due to their positioning at the outermost extremities of a hull, exterior-mounted thrusters benefit significantly from an increased leverage arm in relation to the pivot point on a boat's hull. Their greater efficiency means they can move larger size boats by requiring nominally less power than conventional thrusters.

The dedicated stern thruster models save internal space, install quickly, and can be fitted with cowls if necessary to direct water flow away from any

obstacles on the stern. With the latest addition of the SX35 and SX50 to Sleipner's external thruster program, even more, boats can find space for a stern thruster as these units are the world's most compact external thrusters.

Shared benefits for external thrusters are longer run times, as the surrounding water naturally cools the units. They offer quick and easy installation without the need for fiberglass work.

Another benefit is that these thrusters operate remarkably quiet with their short, optimal tunnel design and submerged placement.

If you previously could not fit a thruster, these models might offer you the perfect solution you have been missing.

Benefits

- Fits where other thrusters won't
- Easy installation that fits many hull shapes and materials. No fiberglass works necessary
- Patented Intelligent Power Control (IPC) protection
- Ultra compact
- Minimal noise emission
- Ignition protected
- Long run times
- Optimal efficiency
- Minimal drag
- Fitted as bow and/or stern thruster



SX35/50







SX80/100



EX Single/Compact/Dual

Product features

-  IGNITION PROTECTION
-  INTELLIGENT POWER CONTROL
-  SEALED DRIVE LUBRICATION
-  GALVANIC SEPARATION
-  Q-PROP™

Technical details

Ideal Vessel Class	Motor boat, Sail boat
Ideal Vessel Size	6–18m / 20–59ft
Power	DC 12/24V
Thrust (12/24V)	42–116kg / 93–256lbs
Tunneldiameter	140–185 mm
Placement	Bow / Stern



SX Thruster	SX35/140 50MM	SX35/140 150MM	SX50/140 50MM	SX50/140 150MM	SX35/140 50POD	SX50/140 50POD
Thrust at 12V (kg)	42	42	62	62	42	62
Thrust at 10.5V (kg)	35	35	50	50	35	50
Ideal Vessel Size (m/ft)	6-10/19-32	6-10/19-32	8-11/27-37	8-11/27-37	6-10/19-32	8-11/27-37
ID (mm)	140	140	140	140	140	140
Single Propeller	Yes	Yes	Yes	Yes	Yes	Yes
Power Output (kW)	1.8	1.8	2.8	2.8	1.8	2.8
Power requirement (V)	12V	12V	12V	12V	12V	12V
Weight (kg)	15.3	15.3	15.3	15.3	15.3	15.3
Min. Battery CCA (DIN)	200	200	350	350	200	350
Item Code 12V	SX35/140-12V-50MM	SX35/140-12V-150MM	SX50/140-12V-50MM	SX50/140-12V-150MM	SX35/140-12V-50POD	SX50/140-12V-50POD
Item Code 24V	-	-	-	-	-	-
Item Code 12V PRO	SXP35/140-12V-50MM	SXP35/140-12V-150MM	SXP50/140-12V-50MM	SXP50/140-12V-150MM	SXP35/140	SXP50/140
Item Code 24V PRO	-	-	-	-	-	-
Cowls	COWL-SX35/50	COWL-SX35/50	COWL-SX35/50	COWL-SX35/50	COWL-SX35/50	COWL-SX35/50

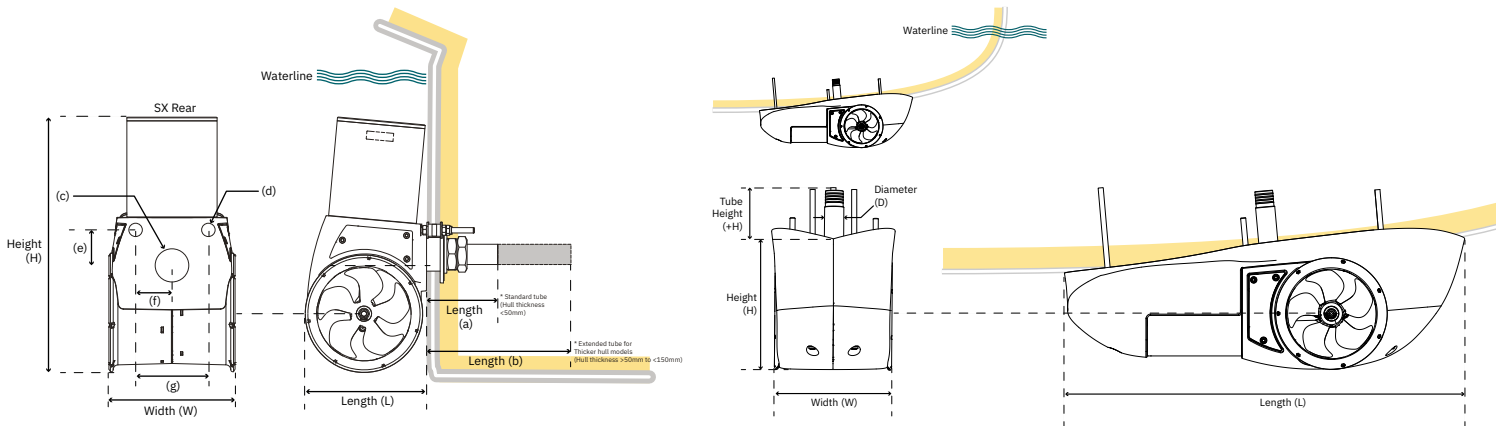

Measurements	SX35/140 -12V-50MM	SX35/140 -12V-150MM	SX50/140 -12V-50MM	SX50/140 -12V-150MM	SX35/140 -12V-50POD	SX50/140 -12V-50POD
mm	12V	12V	12V	12V	12V	12V
(H) Height	374	374	374	374	180	180
(+H) Additional Height	-	-	-	-	183	183
(L) Length	171	171	171	171	630	630
(+L) Additional Length	171	276	171	276	-	-
(W) Width	183	183	183	183	183	183
(a)	35.8	35.8	35.8	35.8	-	-
(b)	50	50	50	50	-	-
(c)	18	18	18	18	-	-
(d)	65	65	65	65	-	-
(e)	130	130	130	130	-	-



SX Thrusters*	SX 80/185 T	SX 100/185 T
Thrust at 12/24V (kg)	96	116
Thrust at 10.5/21V (kg)	80	100
Ideal Vessel Size (m/ft)	10-15/35-48	12-17/35-55
(ID) Internal Diameter (mm)	185	185
Propulsion System	Twin	Twin
Power Output (kW)	4.4	6.3
Power requirement (V)	12/24	12/24
Weight (kg)	52	57
Min. Battery CCA (DIN)	550	750
Item Code 12V	SX80/185T-12V	SX100/185T-12V
Item Code 24V	SX80/185T-24V	SX100/185T-24V
Item Code 12V PRO	SXP80/185T-12V	SXP100/185T-12V
Item Code 24V PRO	SXP80/185T-24V	SXP100/185T-24V
Cowls	90080	90080

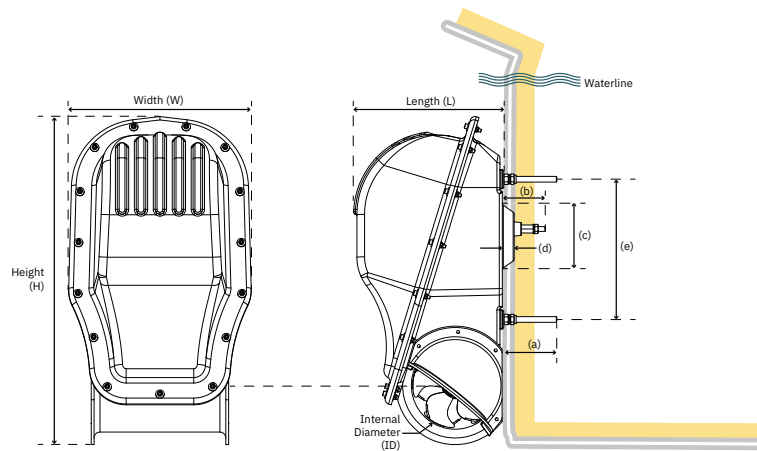

Measurements	SX80	SX100
mm	12/24V	12/24V
(H) Height	692	692
(+H) Additional Height	-	-
(L) Length	314	314
(+L) Additional Length	-	-
(W) Width	361	361
(a)	115	115
(b)	91	91
(c)	140	140
(d)	-	-
(e)	-	-



EX Thruster*	EX70C	EX95S
Thrust at 23V (kg)	67	67
Performance thrust at 24V (kg)	95	95
Ideal Vessel Size (m/ft)	10-15/35-48	10-15/35-48
Tunnel ID (mm)	150	150
Propulsion system	Single	Single
Power Output (kW)	3.0	3.0
Power requirement (V)	24V	24V
Weight (kg)	19.5	19.5
Min. Batt. Cap CCA (DIN)	190	190
Item Code 12V	-	-
Item Code 24V	EX70C	EX95S

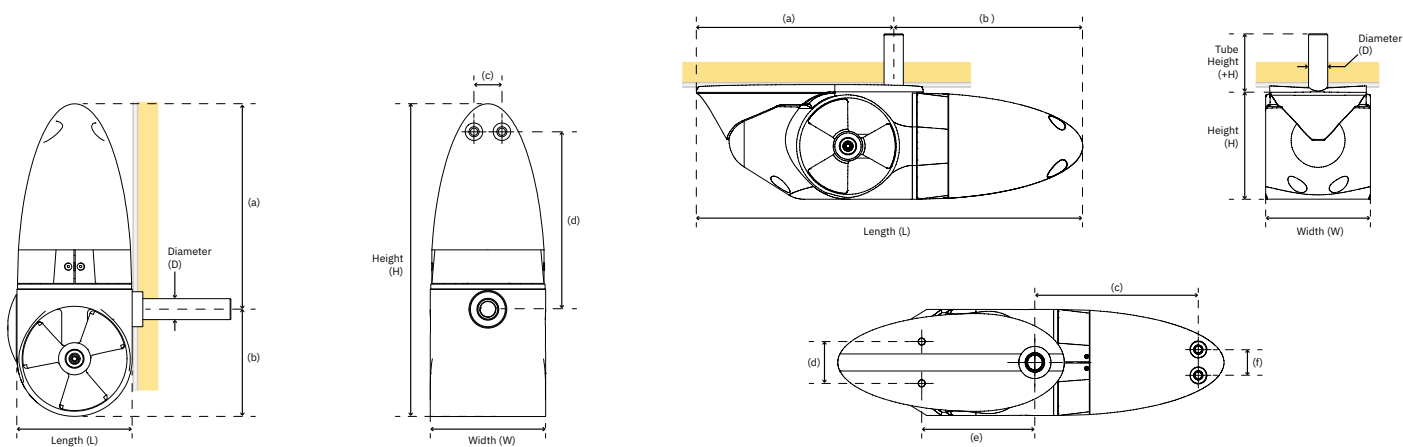

Measurements	EX70C	EX95S
mm	24V	24V
(H) Height	447	165
(+H) Additional Height	-	137.5
(L) Length	165	600
(+L) Additional Length	-	-
(W) Width	165	165
(a)	294	306
(b)	153.5	294
(c)	40	137.5
(d)	254	65
(e)	-	176
(f)	-	254
(g)	-	40

*Note - See page 115



AMI Marine International Pte Ltd

AMI Marine International Pte Ltd

Blk 196 Pandan Loop #4-15,
Pantech Business Hub,
Singapore 128384

Singapore +65 6775 0081
Vietnam +84 (254) 3513 345
A member of the AMI Group

Connect with us:

sales@amisales.com.sg
www.amisales.com.sg

